

HALCYON VECTOR PRO™ FINS

Redefine Your Diving Experience

H_VECTOR PRO FINS

HALCYON

HALCYON™ WORLDWIDE
DIVE SYSTEMS EST. 96

Take your diving to the next level.

Introducing the Halcyon Vector Pro fins: a revolutionary advancement in underwater propulsion meticulously engineered for exceptional performance and versatility. Designed to meet all of your diving needs, these fins are built to excel in any environment, eliminate the need for multiple sets of fins, and save valuable space in your dive luggage.

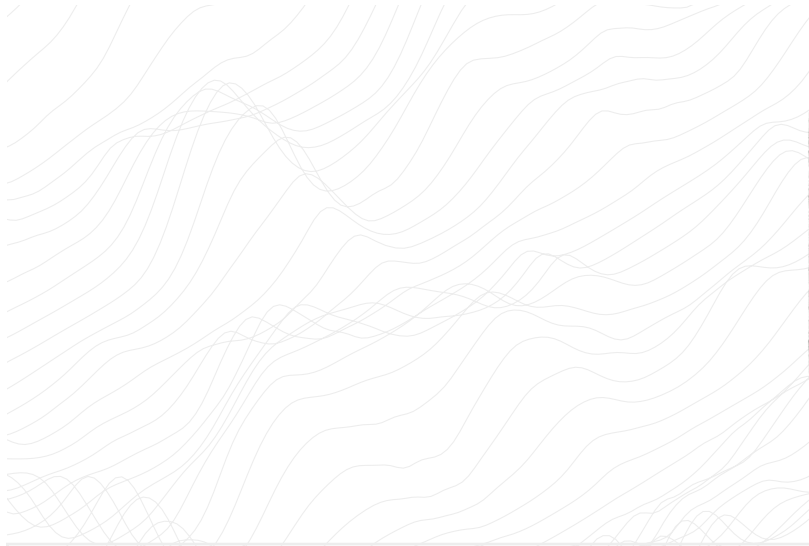

Precision-Guided Shape

The narrowed blade design maximizes thrust, delivers optimal power, and provides extraordinary control.

Inventive Ballast Control System

With six adjustable options, the Vector Pro fins allow you to finely tune from slightly positive to decidedly negative and offer unmatched adaptability to varying dive suits, equipment configurations, and environmental conditions.



Adjustable Spring Heel Strap

The fully adjustable spring heel ensures a perfect fit with quick, easy changes whether you're diving in a wetsuit or a drysuit.

Onboard Accessory Pocket

In addition to ballast control, four onboard compartments can be repurposed to store small items from spares, to rescue dye and more. Future Options coming soon.

Tailored Foot Pocket

The ergonomically designed foot pocket enhances comfort and fit, improves your overall diving experience, and helps you direct power more efficiently.

Versatility Across Environments

Suitable for both recreational and technical divers, the Vector Pro fins perform exceptionally well in a wide range of diving configurations and environments.



Exceptional Maneuverability

Experience superior control, allow for advanced finning techniques like turning and reverse kicking, and appreciate precise adjustments during complex underwater maneuvers.

Anti-Silt Technology

The uniquely shaped blade means that controlling thrust overspray has never been easier, especially in silty and delicate environments. configurations, and environmental conditions.

Future-Proof

Future technology integrations will leverage the onboard accessory pockets and further extend an already remarkable suite of benefits.

Monprene Construction

Crafted from Monprene material, these fins are flexible, durable, and soft to the touch; they also withstand the harsh underwater environment with ease. Monprene is recyclable, supporting environmental sustainability.





High-Grade Stainless Steel Weight Inserts

Available for purchase separately, steel weight inserts allow for customizable weight and balance with at least eight options while configuring each fin.

Convenient Transport Bag

Every pair of Vector Pro fins comes with a handy transport bag and onboard weight pockets, making it easier to arrive prepared at your next amazing diving adventure.



H-VECTOR PRO FINS

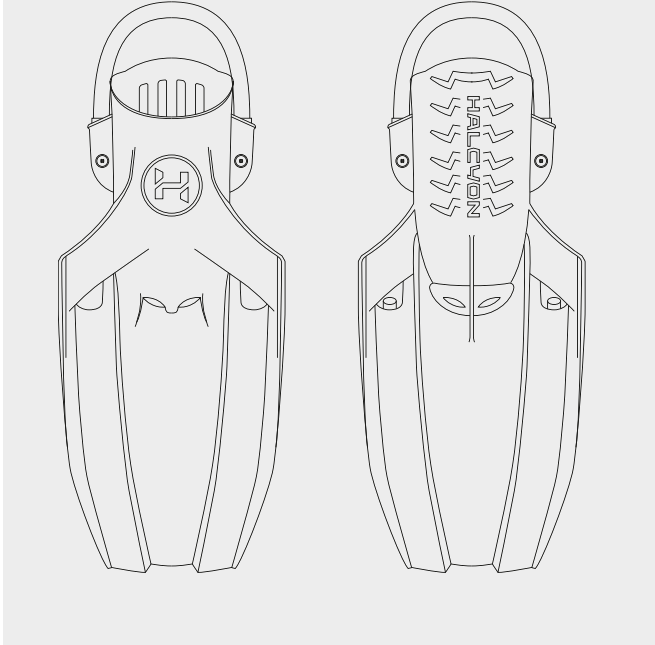

Technical Specifications:

Compatible Foot Pocket Sizes

- / **Medium:** US Men's 5-8, EU 38-41
- / **Large:** US Men's 7-10, EU 40-44
- / **XL:** US Men's 9-12, EU 43-46

Weight

- / Single Fin (with standard weights in): 3.1 lbs (1.41 kg)
- / Pair of Fins: 6.2 lbs (2.82 kg)
- / Single Ballast w/ O-ring: 0.346 lbs (157 g)

Buoyancy Neutral to Negative with Ballast

- / Neutral without Spring strap
- / -.2(91 g) with Springstrap
- / -.5(227 g) with one standard weight
- / -1(454 g) with both Standard Weights
- / -.88(400 g) with one Standard and one Heavy
- / -1.4(635g) with both Heavy Weights

Blade Width:

- / 9.5" (24.1 cm)

Overall Length:

- / 22.75" (57.8 cm)

Spring Strap Adjustments

- 8 possible size adjustments
- / From 12(30.5 cm) to 14(35.6 cm)

The Halcyon Vector Pro fins combine cutting-edge design with the durability and sustainability of Monprene and offer an unparalleled diving experience. Whether you're navigating tight spaces or powering through open water, these fins provide the performance and versatility needed to excel in any diving environment.

Quick Guide

Adjusting Spring Heel Straps

STEP 1

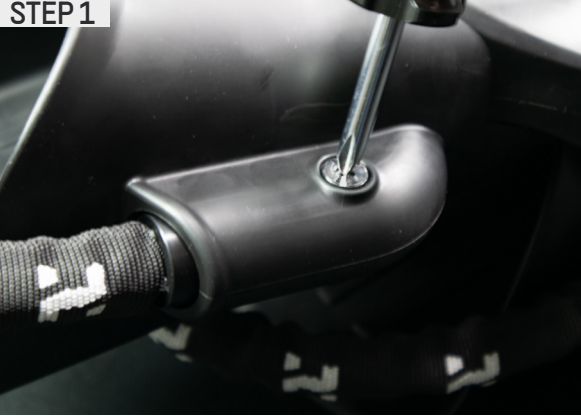

STEP 2



STEP 3-A



STEP 3-B



1. Loosen the Strap Screw

Use a Phillips head screwdriver to loosen the strap screw. Hold the opposite side of the assembly to prevent it from spinning.

2. Remove the Strap

Gently pull the strap out of the fin slot.

3. Extract the Pin

Use a 2 mm Allen key to push the metal pin out. Grab the pin with needle-nose pliers to fully remove it from the cap to detach the string strap.

STEP 4



STEP 5

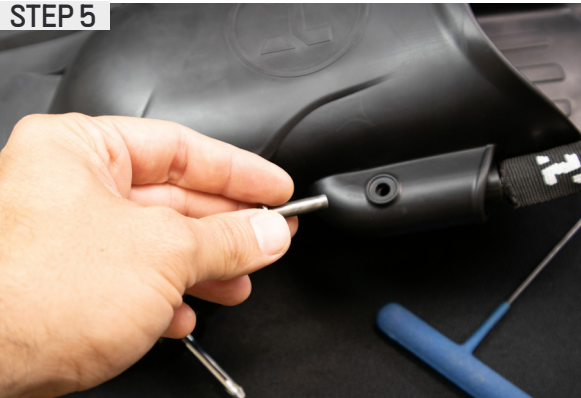

4. Reposition the Strap

Insert the strap back into the cap. Position the pin closer to the strap hole for a looser fit and further away for a tighter fit.

5. Secure the Strap

Rescrew the assembly to securely lock the strap.

Quick Guide

Adjusting Ballast Control System

STEP 1



1. Loosen the Ballast Socket Screw

Use a flathead screwdriver to slowly loosen the ballast socket screw away for a tighter fit.

STEP 2-A



STEP 2-B



STEP 3



STEP 4



2. Remove the Ballast

Push the ballast socket out through the visible gap, then remove the ballast from the assembly.



3. Replace the Ballast

Detach the ballast cap and swap out the existing ballast with your desired replacement.

4. Reassemble the Ballast Socket

Replace the ballast cap, re-insert the socket, and use the screwdriver to securely tighten the screw.

A diver in full gear, including a scuba tank, mask, and fins, is swimming underwater. The diver is positioned horizontally, with their head to the left and feet to the right. They are holding a flashlight in their right hand. The background is a deep blue, slightly hazy underwater environment with a rocky seabed visible at the bottom. The overall tone is dark and professional.

HALCYON